

KYOTO West Chester

1369 Dillworthtown Crossing ~ Rt 202 & Dilworthtown Rd. ~ West Chester, PA 19382 ~ 610-399-9888

Private Event and Meeting Room Specifications

Meeting Room A



- Dimensions - 14' x 19'
- Seats 16 - 35 people depending on configuration
- Standard or custom menus available
- Equipped with tables and chairs
- Table Dimensions: 28" x 46" and 28" x 28"
- Chair Dimensions: 17" w x 21" d

Meeting Room B



- Dimensions - 12' x 17'
- Seats 8 - 20 people depending on configuration
- Standard or custom menus available
- Equipped with tables and chairs
- Table Dimensions: 28" x 46" and 28" x 28"
- Chair Dimensions: 17" w x 21" d

Meeting Room A - Sample Configurations

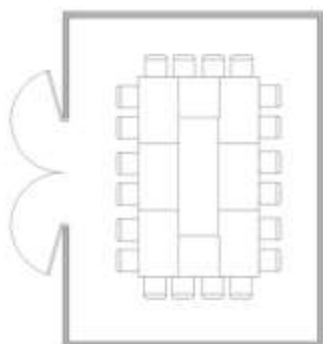

Conference Style
Seats 20+

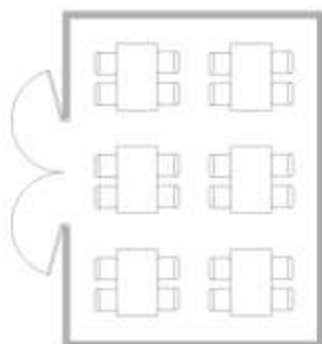

Banquet Style
Seats 24

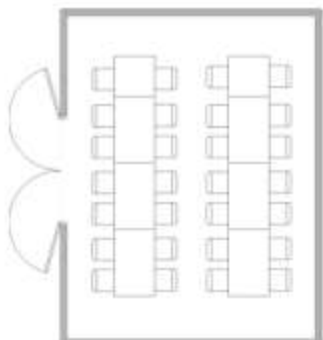

Dual Conference
Seats 28

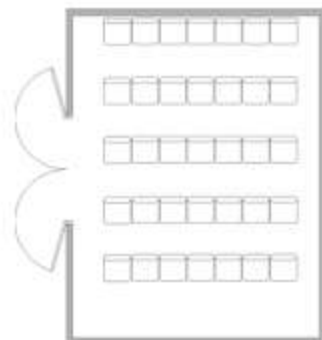

Lecture Style
Seats 35

Meeting Room B - Sample Configurations

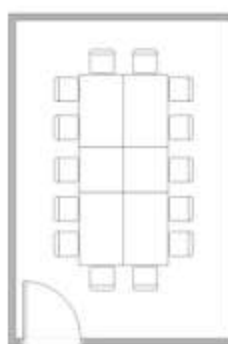

Conference Style
Seats 14

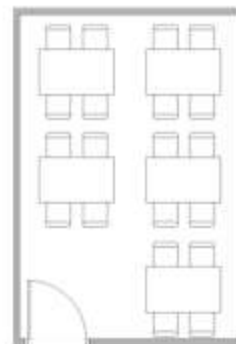

Banquet Style
Seats 20

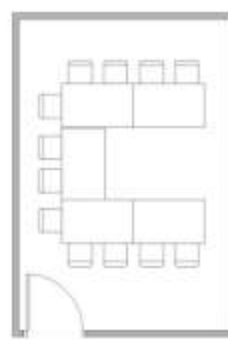

Meeting Style
Seats 12

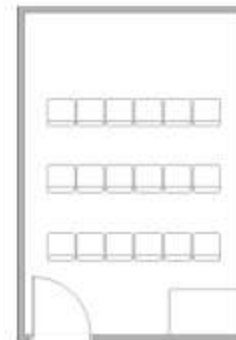

Lecture Style
Seats 18

KYOTO West Chester

1369 Dillworthtown Crossing ~ Rt 202 & Dilworthtown Rd. ~ West Chester, PA 19382 ~ 610-399-9888

Private Event and Meeting Room Specifications

Hibachi Room



Allow our talented and entertaining hibachi chefs to prepare and serve your meal from our Japanese tepanyaki grill. A party atmosphere like no other!

- Room Dimensions - 22' x 30'
- Four tepanyaki grills seating up to 8 people for each grill
- Two grills adjoined in a section so that up to 17 people in a section may be served at the same time by two Hibachi chefs
- Ample room for a presentations area viewable from all seating
- Standard or custom menus available

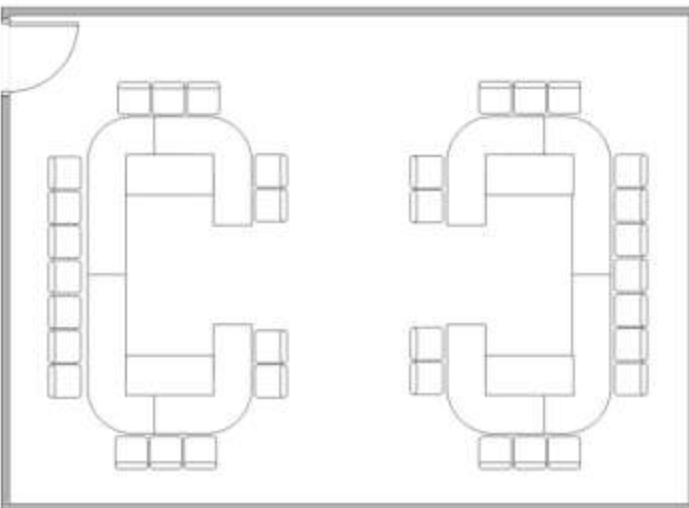

Hibachi Room

**Still need more space?
Call us about renting the entire
restaurant for a private party.**

Upper Dining Area



Need more room or a perhaps an empty room to fill with people?

Extremely versatile, our upper dining area is perfect for large sit down dinners or cocktail parties & networking events without tables and chairs. Leave the room length cushioned bench seating in place or take it out. Leave the window shades up and enjoy the view or draw them closed for more privacy. The choices are yours.

- Dimensions - 15' x 36' approximately
- Seats 40 people in standard dinner configuration
- Comfortable, cushioned, removable benches line one wall
- Large picture windows along the front side
- Remove tables and chairs for a cocktail party
- Equipped with tables and chairs
- Table Dim: 28" x 70" / 28" x 46" / 28" x 28"
- Chair Dimensions: 17" w x 21" d
- Standard or custom menus available



Full Dining Room



Upper Dining Area